

## **HERE@Stevens**

# **Team Information Packet**

Saturday June 14, 2014

Stevens Institute of Technology

### Tournament Info

Introduction

This Year's Game

What to Bring & Check In

Competition Schedule

Tournament Layout

### Venue Info

Driving Directions

Map of Campus

### Parking

Cars

Buses

Load In

### Food

# Introduction

Welcome and thank you for being a part of HERE@Stevens! We are truly fortunate to have such a committed group of people who share in the FIRST mission to inspire the next generation to celebrate science and technology. Thank you for your time. We hope that you will have a rewarding and thoroughly enjoyable experience.

## **What is FIRST?**

FIRST (For Inspiration and Recognition of Science and Technology) was founded by inventor Dean Kamen to inspire young people's interest and participation in science and technology. Based in Manchester, N.H., the 501 (c) 3 not-for-profit organization designs accessible, innovative programs to build self-confidence, knowledge, and life skills while motivating young people to pursue opportunities in science, technology, engineering, and math.

FIRST provides the FIRST Robotics Competition for high-school students and the FIRST LEGO League (FLL) for 9 to 14 year-olds. FIRST also offers the Junior FIRST LEGO League (JrFLL) for 6 to 9 year-olds and the FIRST Tech Challenge (FTC), a mid-level robotics competition that offers students (from 7th-12th grades) a more affordable and accessible opportunity to participate in FIRST. For more information, visit the FIRST website at [www.usfirst.org](http://www.usfirst.org).

## **What is HERE@Stevens?**

The Hoboken Engineering Robotics Event (HERE) is a brand new offseason event at Stevens Institute of Technology. Here is an opportunity to enjoy the environment of a FIRST FRC event while inquiring about the experiences of many college students and professors.

# This Year's Game

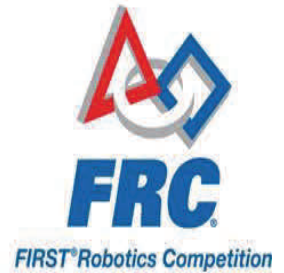
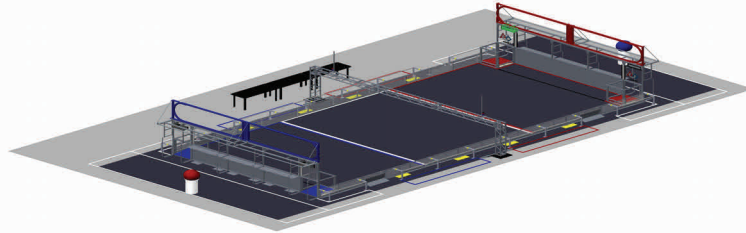

AERIAL ASSIST is played by two competing Alliances of three Robots each on a flat 25' x 54' foot field, straddled by a lighting truss suspended just over five feet above the floor. The objective is to score as many balls in goals as possible during a 2 minute and 30 second match. The more Alliances score their ball in their goals, and the more they work together to do it, the more points their alliance receives.

The match begins with one 10-second Autonomous Period in which robots operate independently of driver. Each robot may begin with a ball and attempt to score it in a goal. Alliances earn bonus points for scoring balls in this mode and for any of their robots that move in to their zones. Additionally, each high/low pair of goals will be designated "hot" for five seconds, but the order of which side is first is randomized. For each ball scored in a "hot" goal, the Alliance earns additional bonus points.

For the rest of the match, drivers remotely control robots from behind a protective wall. Once all balls in autonomous are scored, only one ball is re-entered in to play, and the Alliances must cycle a single ball as many times as possible for the remainder of the match. With the single ball, they try to maximize their points earned by throwing balls over the truss, catching balls launched over the truss, and scoring in the high and low goals on the far side of the field.

Alliances receive large bonuses for "assists," which are earned for each robot that has possession of the ball in a zone as the ball moves down the field. Points are awarded for each action per the table below.

Action	Base	AUTO (=Base+5)	AUTO & HOT (=Base+AUTO+5)	1 ASSIST (=Base+0)	2 ASSIST (=Base+20)
LOW GOAL	1	6	11	1	21
HIGH GOAL	10	15	20	10	30
TRUSS	10				
Mobility		5			
CATCH	10				

# What to Bring & Check In

## WHAT TO BRING

As always, please bring safety glasses and a multi-outlet extension cord for team use. Along with your charger and spare batteries, it is smart to bring a few other spare parts such as motors and motor controllers. It is also smart to mark your battery packs and other items which could conceivably get mixed with those of another team.

## Early Robot Drop Off

Teams may arrive between 3-8 pm on June 13 to drop off their robot. Practice matches may be given if the field and robots are ready.

## TEAM CHECK-IN

The majority of the team should report immediately to their table in the Pit Area.

Pit Tables are marked with Team Numbers.

Only Coach/Mentor and 1-2 team members should check-in at Pit Administration to pick up any information updates and schedule changes.

## SAFETY

Safety Glasses are mandatory at HERE@Stevens. All team members and their guests are expected to behave in a safe manner and obey all safety rules. Individuals not acting safely will be asked to leave the event premises. Please notify an Event Crew member if you have any safety issues or concerns. Please report any illness or injuries to the event organizers.

## Emergency Contact Information

In case of Emergency, Howard's cell phone number is 732-407-8839.

The Campus Police number is 201-216-5105.

## Rule Changes

- \* Matches will be run 2v2
- \* 1 Assist, like normal, will be worth +0 points. 2 Assists will be +20 ( +10 more than usual Arial Assist game)  
  
Example: Team A is in the blue zone and has possession and gives the ball to Team B in the red zone and has possession these 2 assists are worth +20 points making the low goal scored 21 points and high goal 30 points
- \* Mentors may control the robot during qualifiers, but students must control the robot during eliminations.

# June 14, 2014- Competition Schedule

7 AM	Volunteers Arrive Doors Open
8 AM	Drivers Meeting
8:30 AM	Opening Ceremonies Expected 7 matches/team
12:30 PM	Alliance Selection
2:30 PM	Final Rounds
4:30 PM	Closing Ceremonies

# Tournament Layout

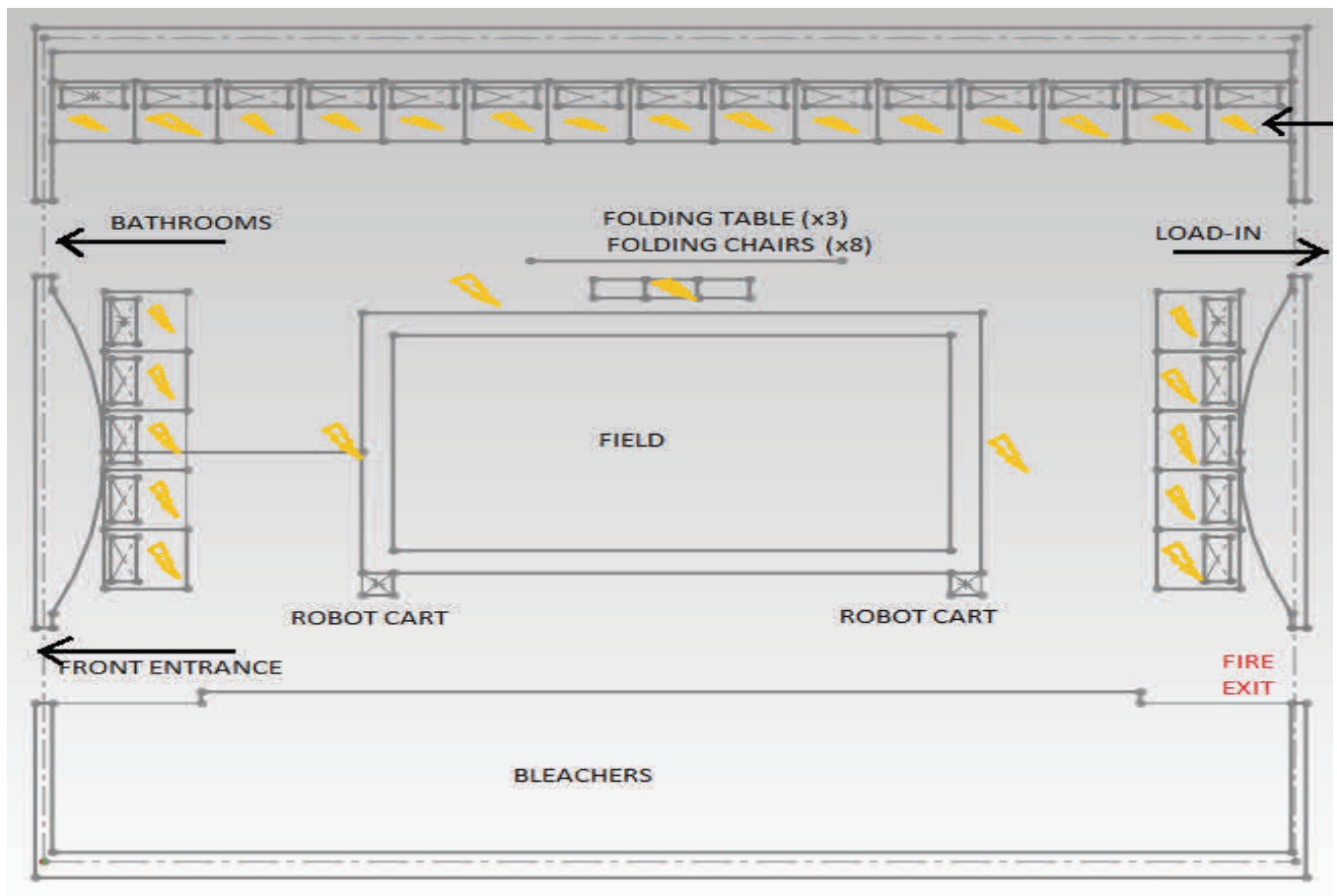
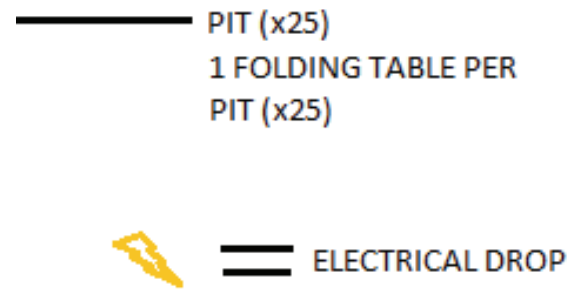

# Driving Directions

<http://www.stevens.edu/sit/maps/driving-directions>

## **From the NJ Turnpike exit 14c**

At the first traffic light after the tollbooth, turn left on Jersey Avenue.

Follow the road as it curves under the train trestle.

The road becomes Newark Avenue, and then Observer Highway.

When you reach the light at Washington Street, turn left.

Proceed up Washington and turn right onto Ninth Street.

Go two blocks, and enter the gate to the Stevens campus.

## **From routes 3 & 495 east**

Follow signs to Hoboken (the sign will read “Last Exit Before Tunnel, Hoboken/Weehawken”).

Turn right at the second traffic light onto Park Avenue.

Follow the road over viaduct and turn left onto 14th Street.

Turn right onto Washington Street.

Turn left onto Ninth Street, proceed two blocks, and enter the gate to the Stevens campus.

## **From the Lincoln Tunnel**

Upon exiting the tunnel, follow the signs to Hoboken.

From the North tube of the tunnel, bear to the extreme right and go through the underpass marked Hoboken.

From the South tube, bear to exit ramp on left. This places you Southbound on Willow Avenue.

Continue over the land bridge into Hoboken and make a left at 14th Street

Then turn right onto Washington Street.

Make a left on Ninth Street and enter the gate to the Stevens campus.

## **From Public Transportation (PATH, Ferry, Train, Lightrail, or Bus)**

Once in the Hoboken South Terminal, take a local

Washington Street bus, taxi, or take the 10-minute walk

uptown to Sixth Street and turn right (east) to enter the

Stevens campus.



# Map of Campus

Event: Schaefer Center



Driving Directions Bring You HERE



Additional Parking

Regular Parking





# Map of Campus

Event: Schaefer Center



Driving Directions Bring You HERE



Additional Parking



Regular Parking





# Map of Campus

Event: Schaefer Center



Driving Directions Bring You HERE

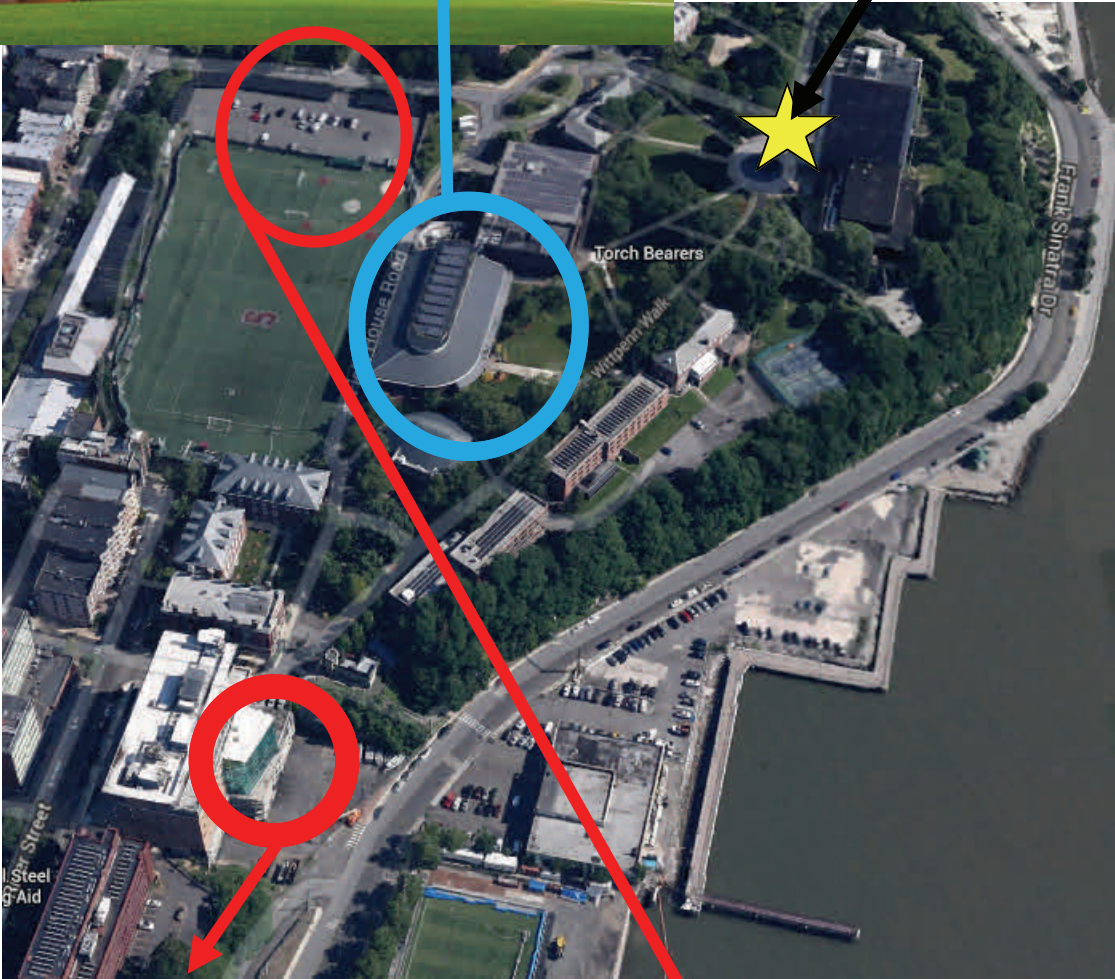

Additional Parking

Regular Parking



# Parking

Cars will be parking in the 8th Street Parking Lot

## Directions to Parking Lot from Campus:

Go down 8th Street to Castle Point Terrace

Parking Lot is on the left

(If you reach Hudson Street, you went too far)

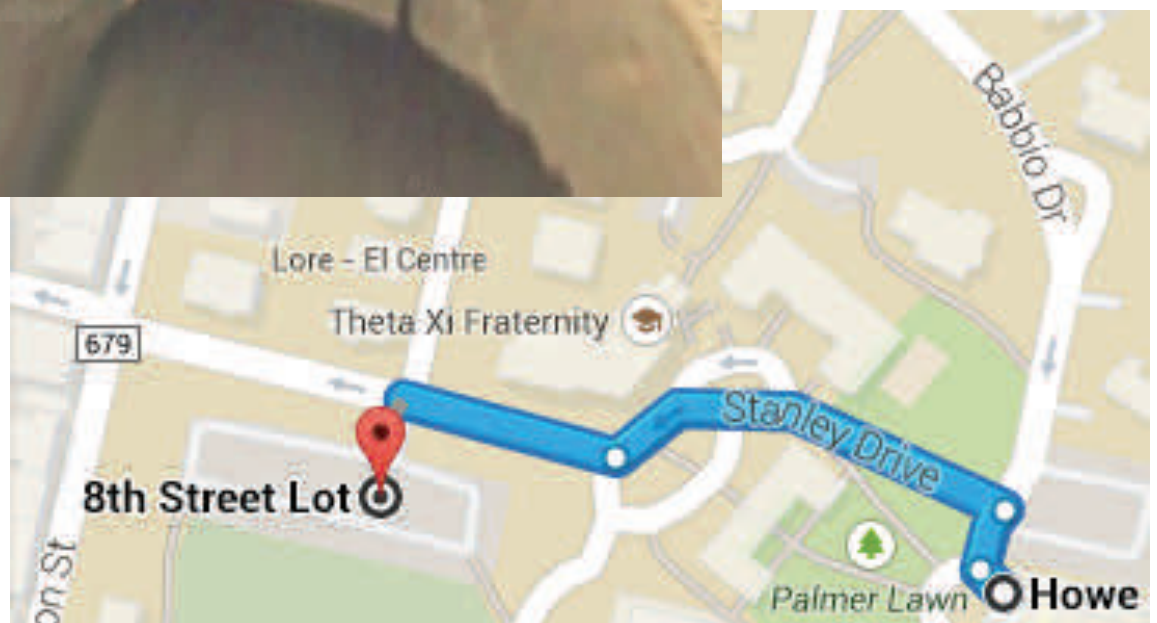



# Additional Parking

If 8th Street Lot is full then Babbio Garage is available

## Directions to Garage from Campus:

Go down 8th Street to Hudson Street

Turn left on Hudson Street

Turn left on Hudson Street

Follow the hill down to Frank Sinatra Drive (past the park)

Turn left and the garage is immediately on your left

(Across from the Soccer Field)

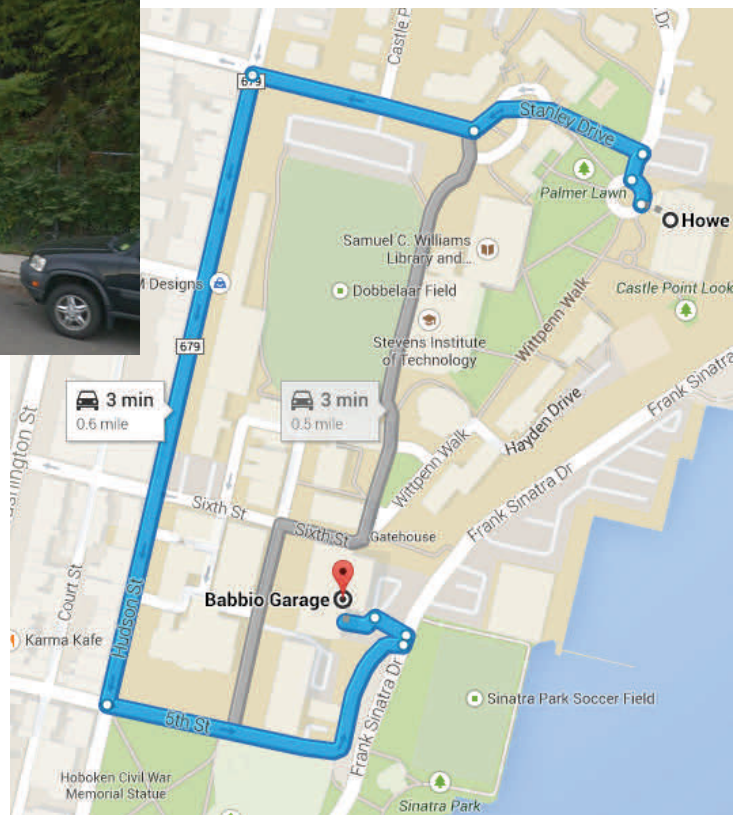

# Bus Parking

Buses will be parking on the 5th Street Hill

Buses can also park in the Babbio Lot (see Additional Parking)

## Directions to Hill from Campus:

Go down 8th Street to Washington Street

Turn Left on Washington and 5th Street

Turn Left on 5th Street

Continue down near the park for parking space

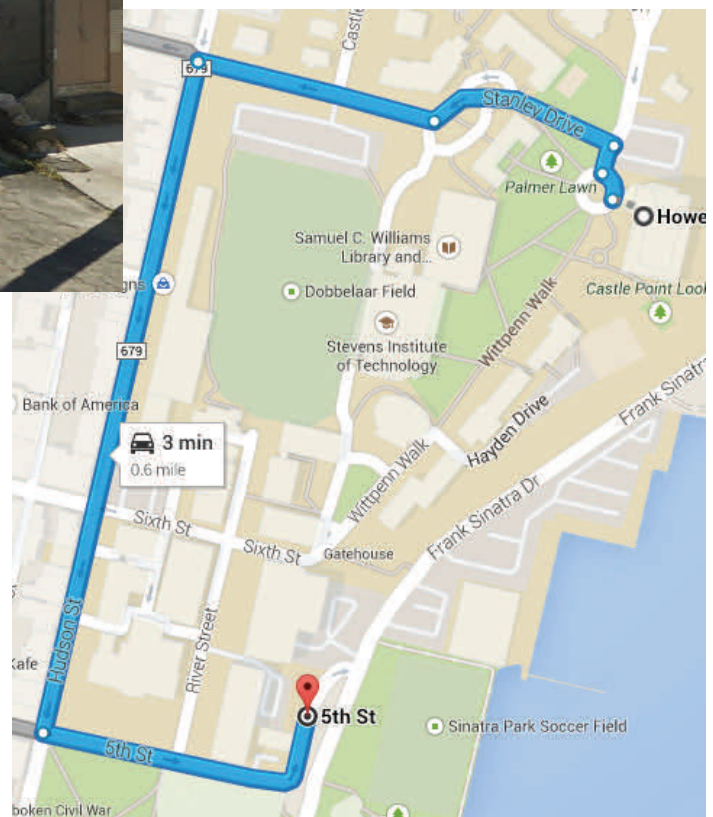

# Load In

You can bring materials to the back of Schaefer gym (near the soccer field)

Directions from Campus

go down 8th street

Follow the circle towards the soccer field





# Pizza from Giovanni's Pizzeria

**Large \$20 (any toppings, any flavor)**

**Cheese \$15 (plain)**

## Toppings

Extra Cheese	Pepperoni	Sausage	Onion	Pepper	Meatball	Eggplant
Mushroom	Fresh Garlic	Black Olive	Fresh Tomato	Anchovies	Broccoli	Spinach

## Specialties

Primavera

Pepper, Onion, Mushroom, Tomato, Spinach, Broccoli

Margarita

Mozzarella, Tomato, Basil

Giovanni's Special

Pepperoni, Mushroom, Sausage, Pepper, Meatball, Onion

Pizza Bianca

Ricotta, Mozzarella

Hawaiian

Ham, Pineapple

Vodka Sauce

Chicken

Buffalo Chicken

Sicilian

Team Number: \_\_\_\_\_

Number of Pies: \_\_\_\_\_

Flavors:

1.

2.

3.

4.

5.

6.

Total Price: \$ \_\_\_\_\_

Administrative Use

Payment Accepted by: \_\_\_\_\_

If you accept money, sign above and make sure filled  
out completely