

Automatic-Fastening Sets

item Innovation
German patent
and foreign patents
EP 0 458 069

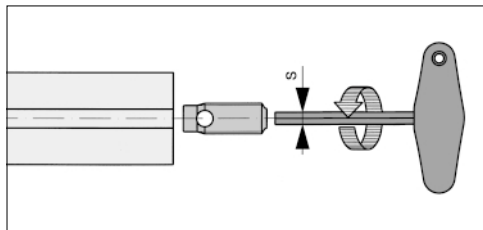

For universal power-lock connection of all profiles of one Line. Suitable for profiles which need to be moved subsequently, since the Fasteners are only screwed into one profile. These Fastening Sets can be installed easily into existing constructions. The profiles do not need to be machined in order to use the Automatic-Fastening Sets.



The Fastener is screwed into a profile groove in the end face, the thread being cut automatically. Use of a lubricant is recommended.

Note: All Fasteners with a through bore for the fastening screw have a counter-clockwise thread on the outside in order to prevent the Fastener twisting when the screw is tightened.

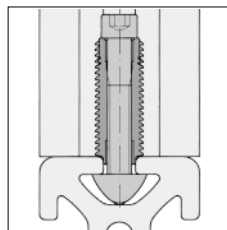
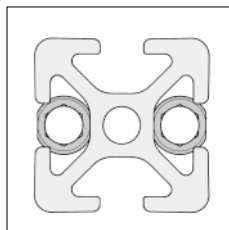
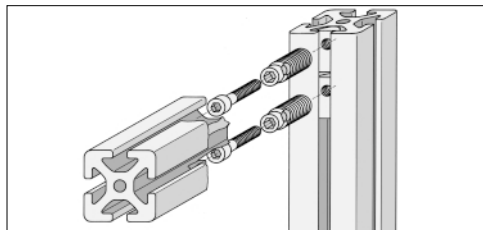

Automatic-Fastening Set 5 should be inserted so that the flattening on the thread is flush with the outer edge of the profile.

With Automatic-Fastening Sets 6 and 8, twisting can be prevented by screwing out the Fastener (after the profile has been assembled) until the head of the Fastener projects into the other profile groove.

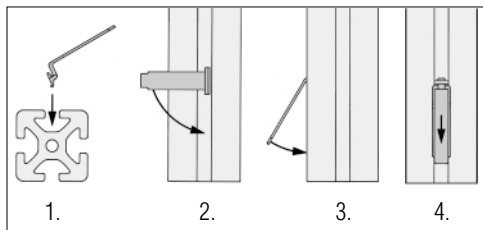

Automatic-Fastening Set 8 also contains a Cap which can be fitted subsequently over the Fastener.

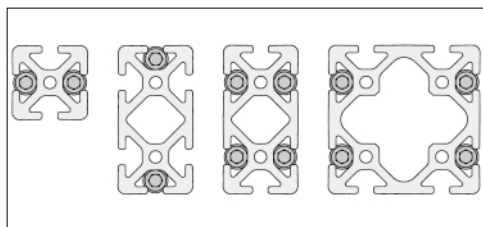

Automatic-Fastening Sets should always be used in pairs.