

D  
C  
B  
A

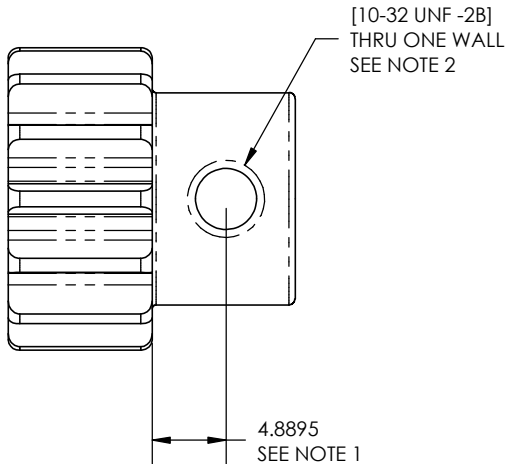
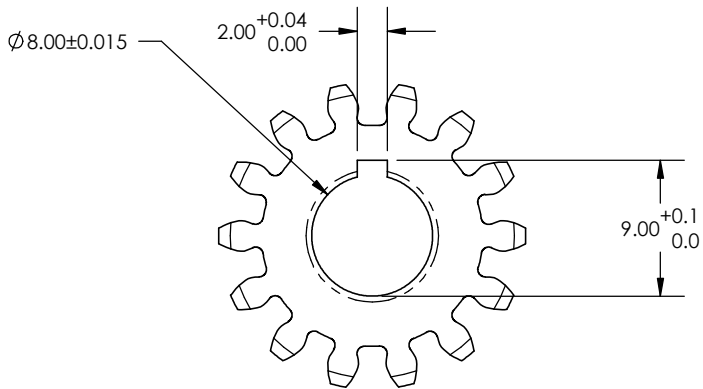

NOTES:

- IF STANDARD HOLE LOCATION IS DIFFERENT, THEN THIS DIMENSION CAN BE DISREGARDED.
- [10-32 UNF -2B SET SCREW MUST BE SUPPLIED WITH GEAR.
- ALTERED STANDARD MATERIAL:  
A. MARTIN GEAR #S2014-5/16 - 20DP, 14 TEETH, 14.5° P.A. WITH #35 DRILLED HOLE.  
B. BOSTON GEAR #NA14B-5/16 - 20DP, 14 TEETH, 14.5° P.A. WITH #35 DRILLED HOLE.  
C. EQUIVALENT GEAR MEETING DIMENSIONAL REQUIREMENTS.

MATERIAL: SEE NOTE 3	
HEAT TREAT: _____	
CASE DEPTH: _____	
HARDNESS: _____	
SURF TREAT: _____	
OTHER _____	

ECN	REV	ZONE	CHANGE	DATE	BY
E5001	A		RELEASED	8/5/04	PDC

DO NOT SCALE DRAWING

THE FOLLOWING ITEMS APPLY UNLESS OTHERWISE SPECIFIED:  
ALL GEOMETRIC DIMENSIONING AND TOLERANCING TO BE INTERPRETED PER THE AMERICAN NATIONAL STANDARD ASME Y14.5M - 1994.  
  
FOR FEATURES - OF - SIZE PERFECT, STRAIGHTNESS NOT REQUIRED AT MMC.  
FOR DIAMETRAL FEATURES, ROUNDNESS MUST BE WITHIN THE MMC AND LMC BOUNDARY.  
TRUE POSITION TOLERANCES AND RELATED DATUMS (EXCEPT PLANE SURFACES), APPLY AT MMC.  
Ⓢ SYMBOL = RFS FOR TRUE POSITION ONLY.  
OTHER GEOMETRIC TOLERANCES AND RELATED DATUMS, APPLY RFS.  
SEPARATE TRUE POSITION CALLOUTS MAY BE GAGED SEPARATELY, REGARDLESS OF DATUM REFERENCE.

METRIC

UNLESS OTHERWISE SPECIFIED  
ALL DIMENSIONS ARE IN MILLIMETERS.  
ALL ONE PLACE DECIMAL DIMENSIONS ±0.2.  
ALL TWO PLACE DECIMAL DIMENSIONS ±0.10  
ALL THREE PLACE DECIMAL DIMENSIONS ±0.012  
ALL MACHINED ANGLES ±0-15°  
CSINK ALL TAPPED HOLES.  
REMOVE ALL BURRS AND SHARP CORNERS.  
UNFINISHED CASTING AND WELDMENT DIMENSIONS ±3.0  
BURNOUT DIMENSIONS ±3.0  
DO NOT USE REF. DIMENSIONS FOR MANUFACTURING.  
DIMENSIONS IN [X.X] ARE IN INCHES.

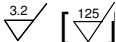

PART IDENTIFICATION, PRESERVATION, LABELING, AND PACKAGING SHALL BE IN ACCORDANCE WITH FIRST SUPPLIER QUALITY ASSURANCE DOCUMENTS.

FIRST

200 Bedford Street, Manchester, N.H. 03101  
(603) 666-3906 • FAX (603) 666-3907

TITLE: CIM MOTOR INPUT GEAR		
DRAWN BY: P.D.C.		DATE: 8/5/2004
CHECKED BY: C. JOST		DATE: 8/5/2004
APPR'D BY: H. SNOW		DATE: 8/5/2004
SHEET SIZE: B	SCALE: 2:1	
SHEET NO. 1	TOTAL SHEETS 1	DRAWING PART NO./PART NO. FRC-2005-111-007

A