

the Order of the
SecOnd Day *presents*

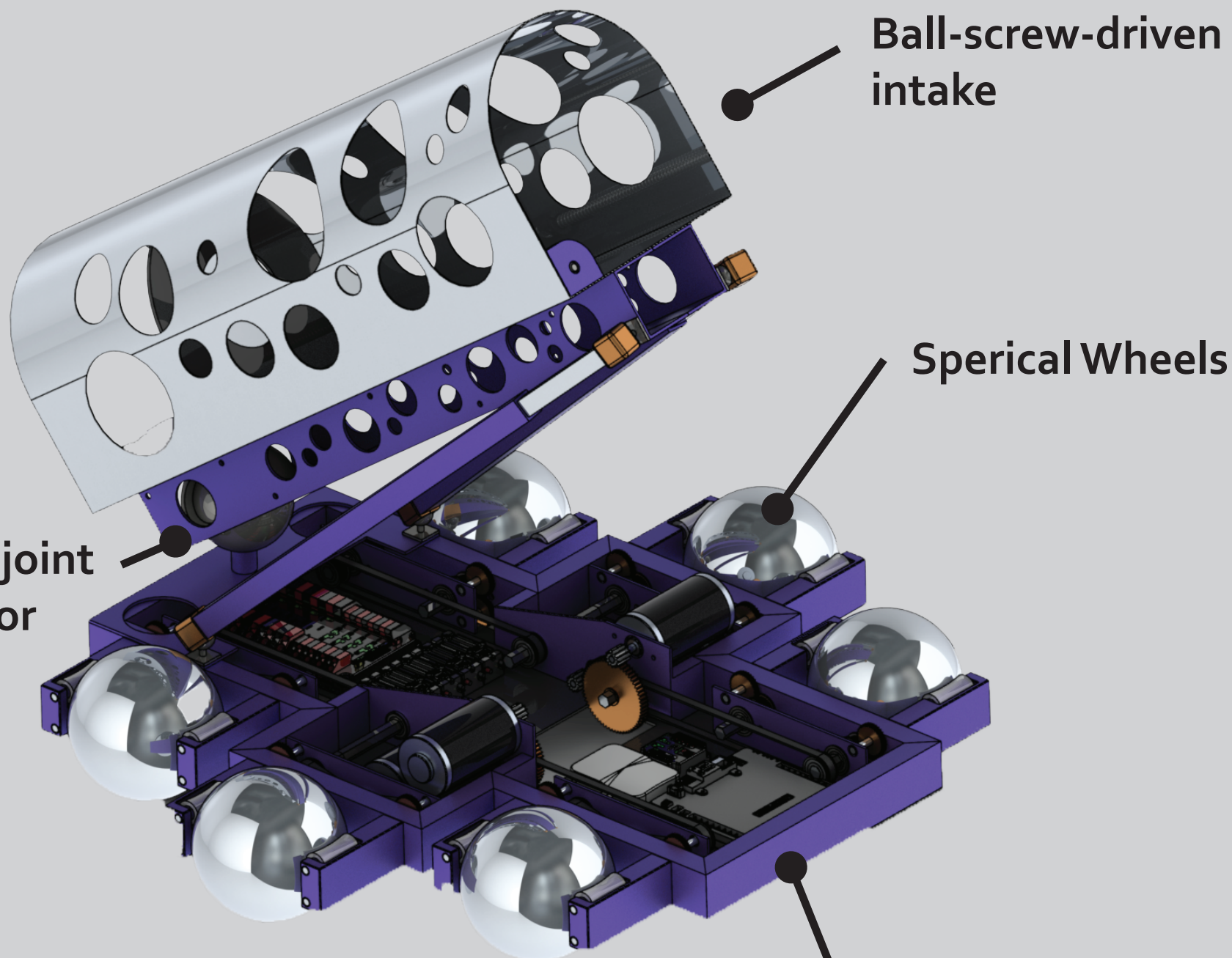

The Big One



2DOF ball-joint
manipulator

Ball-screw-driven
intake

Spherical Wheels

Designed in Metric

Utilizes proprietary **Bal-tec™** Infinity Belts, which provide simple, on-plane motion reversal by adopting Seventh Degree of Freedom Thinking.

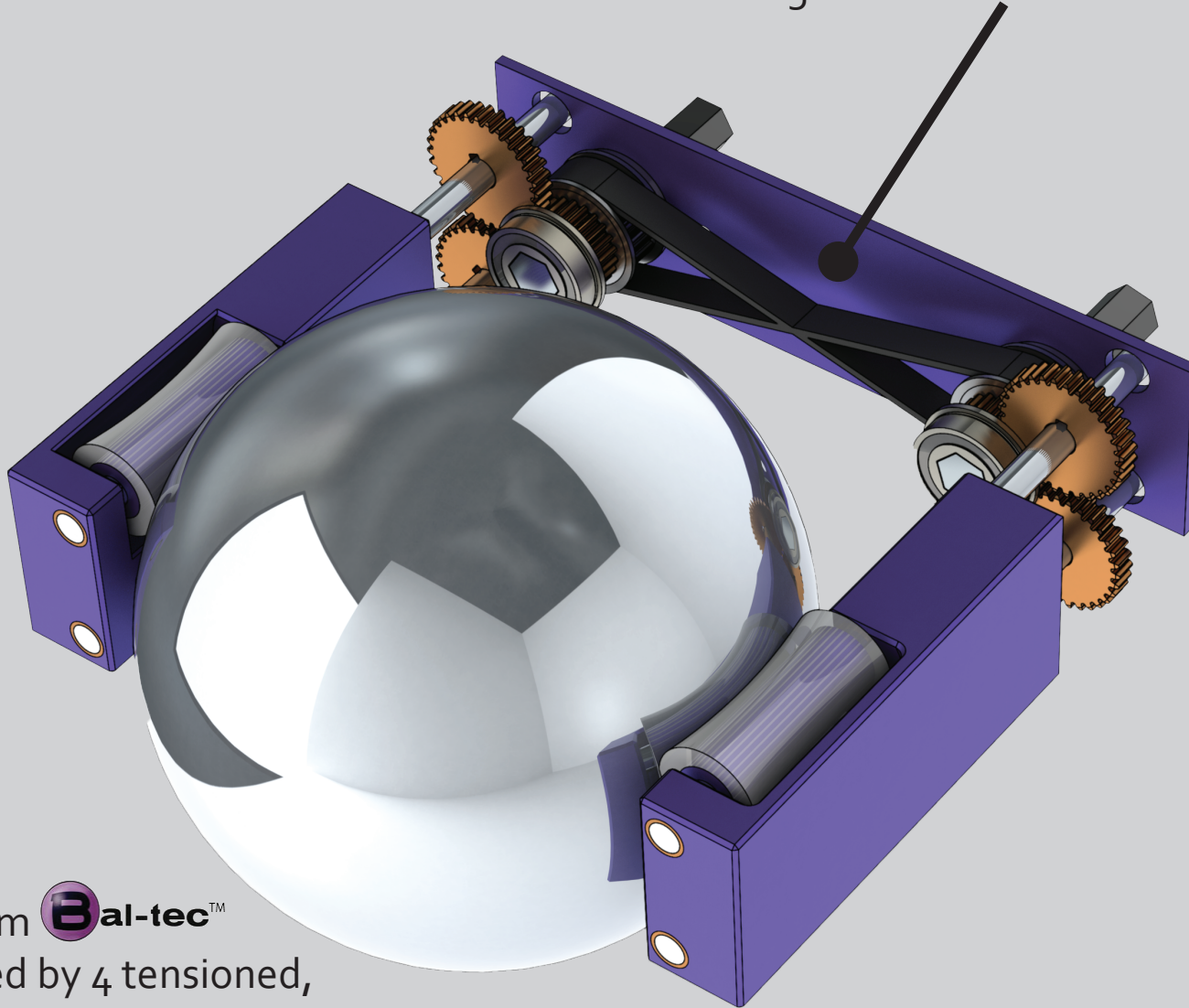

Hollow aluminum **Bal-tec™** balls, constrained by 4 tensioned, driven rollers. Like wheels, but 3D.

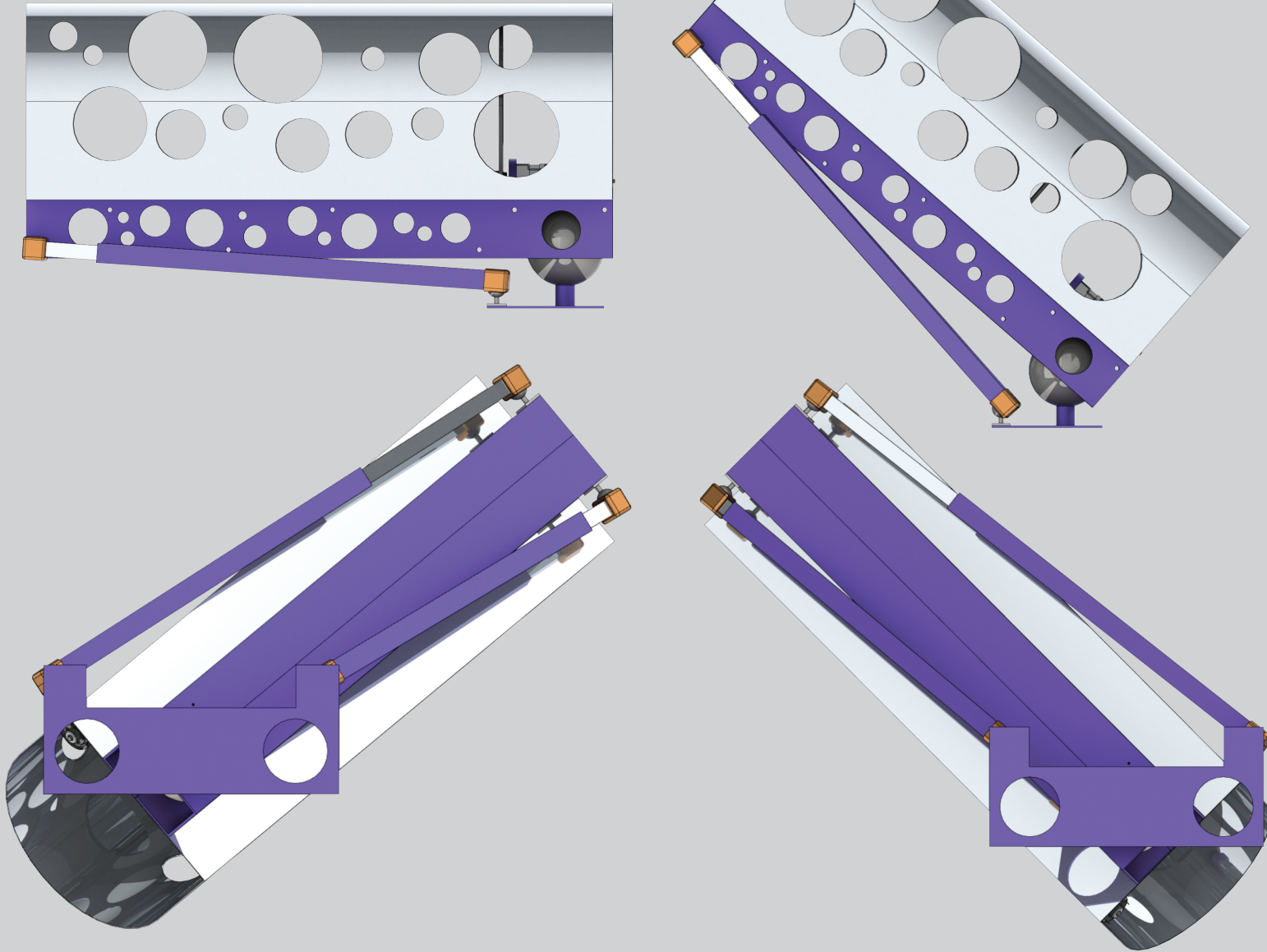

The manipulator is mounted on a 4"  **Bal-tec**™ Kinematic Element, and is actuated by a pair of ball-screw linear actuators. The large 2-dof range of motion allows for precise and flexible alignment during the match.

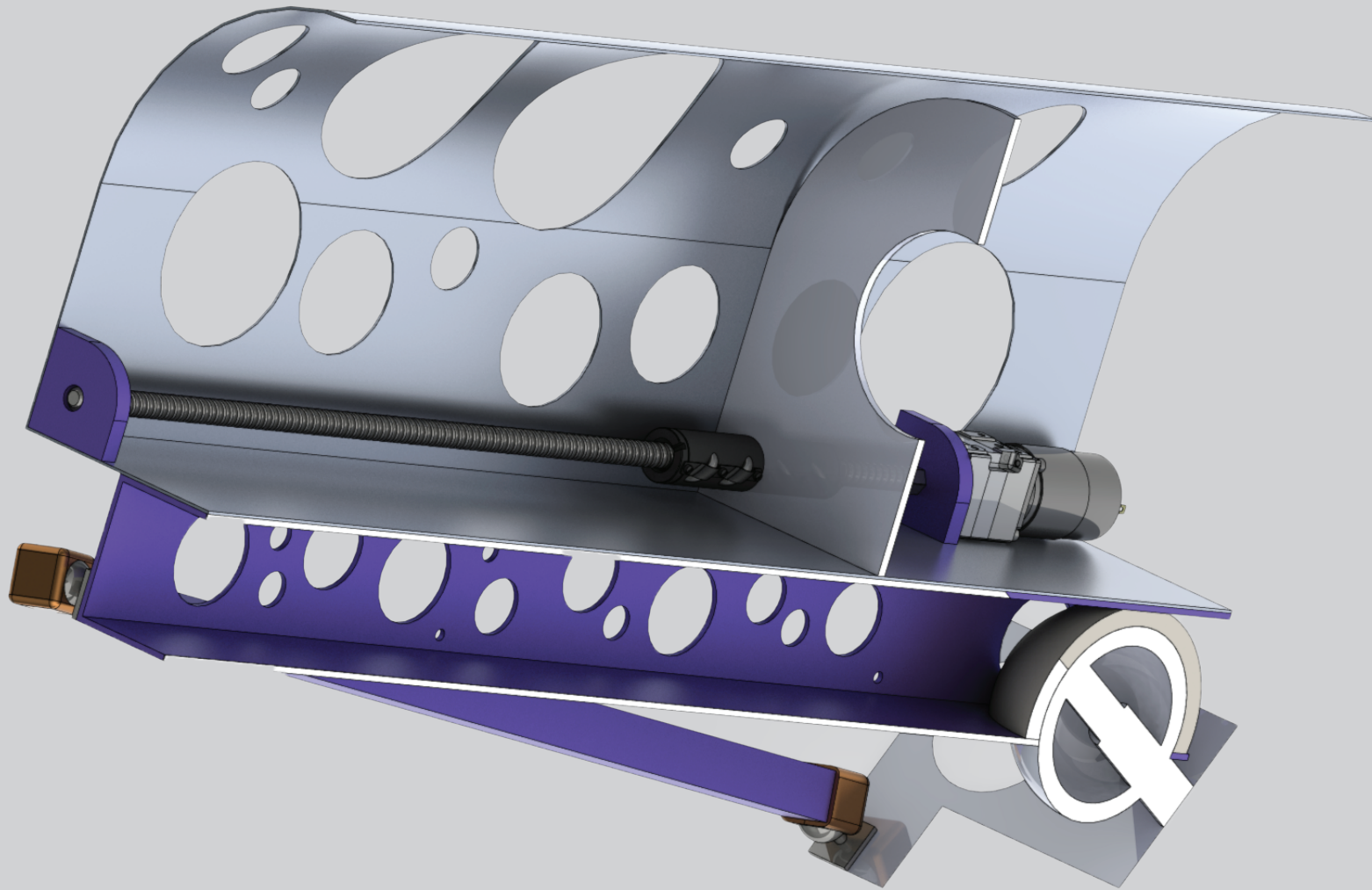

The intake receives balls from the human player station. To score, the ball-screw driven paddle pushes the spheres back out.

During endgame, the robot yeets itself into the bottomless void.

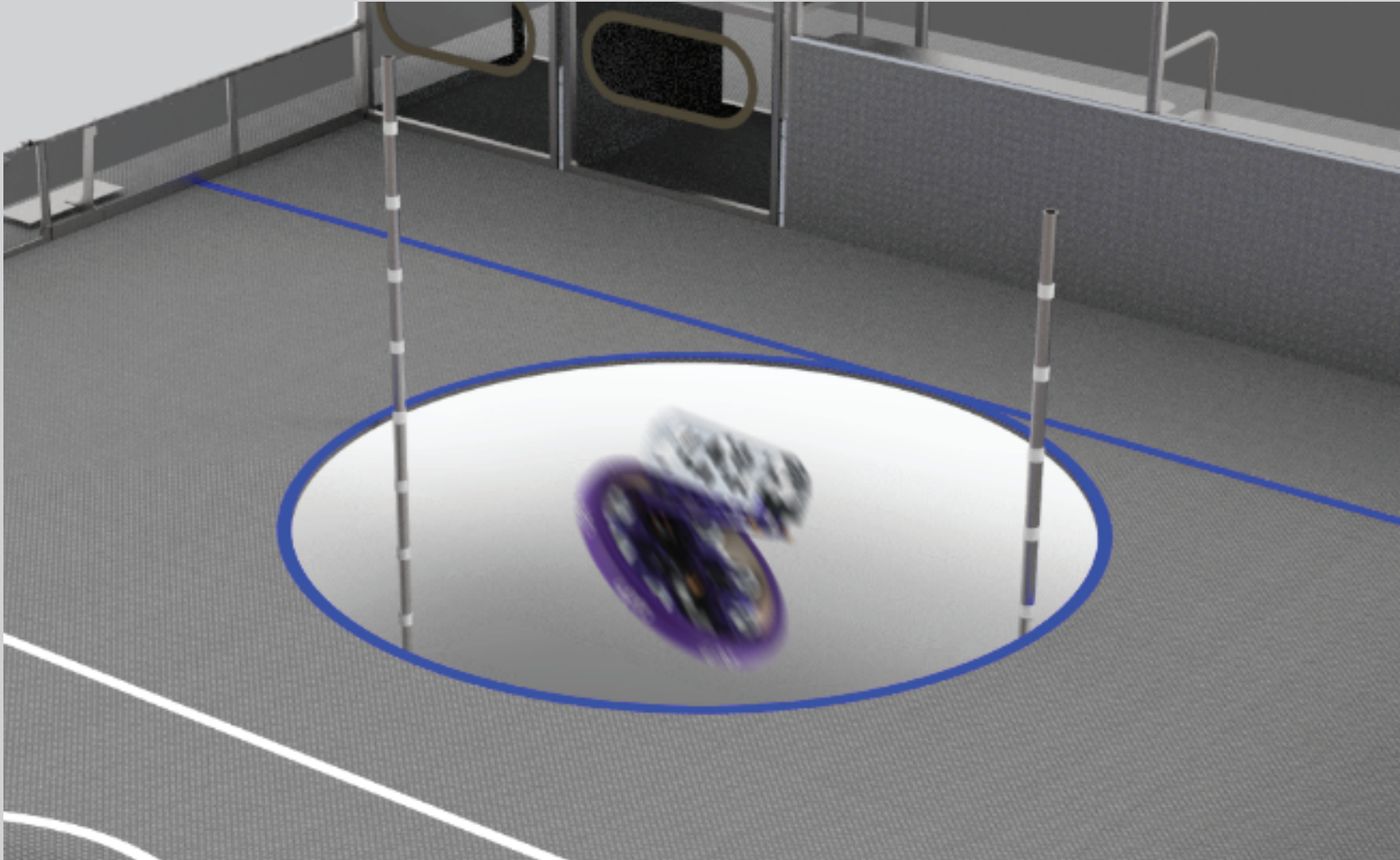

The call of an infinite circle is irresistible.

